



IntraEligo

intra
SCANDINAVIAN DESIGN



A COMPANY OF THE **teka**-GROUP





SVENSKA

Modeller
Förberedelser
Ursågning
Installation
Elektronik – standard
Elektronik – DW
Tillbehör
Tekniska data
Driftsproblem
Service

NORSK

Modeller
Forberedelse
Utskjæring
Installasjon
Elektronikk – standard
Elektronikk – DW
Tilbehør
Tekniske data
Driftsproblem
Service

ENGLISH

Models
Preparation
Cut-out
Installation
Electronics – standard
Electronics – DW
Accessories
Technical data
Operating problems
Service

DEUTSCH

Modelle
Zubereitung
Ausgeschnitten
Installation
Elektronik – Standard
Elektronik – DW
Zubehör
Technischen Daten
Bedienungsprobleme
Service



EL58SF

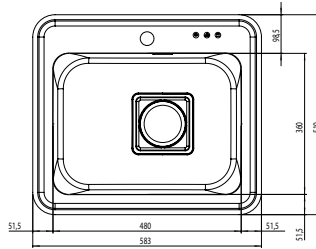

EL94SLF | EL94SRF

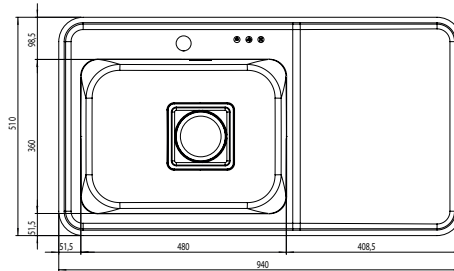

EL78SXF

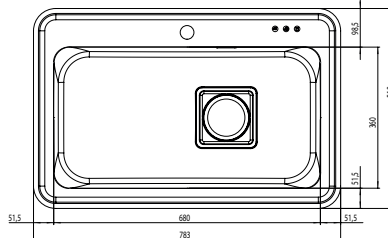

EL114SXLF | EL114SXRf

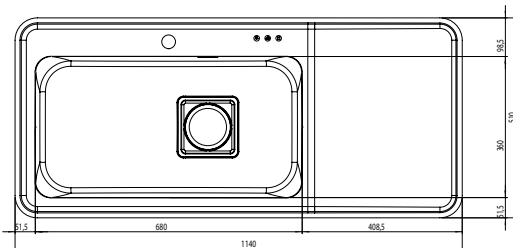



Förberedelser | Forberedelse | Preparation | Zubereitung

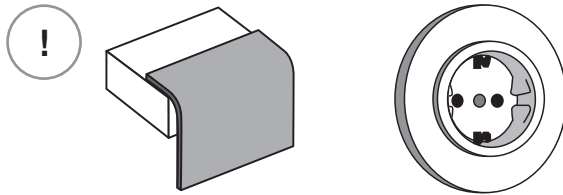

Inkluderat | Inkludert | Included | Inbegriffen

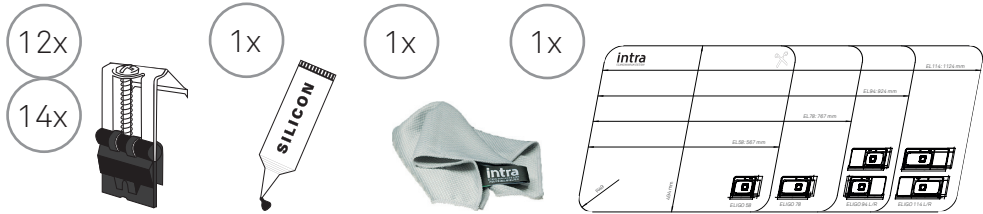

Verktyg | Verktøy | Tools | Werkzeug

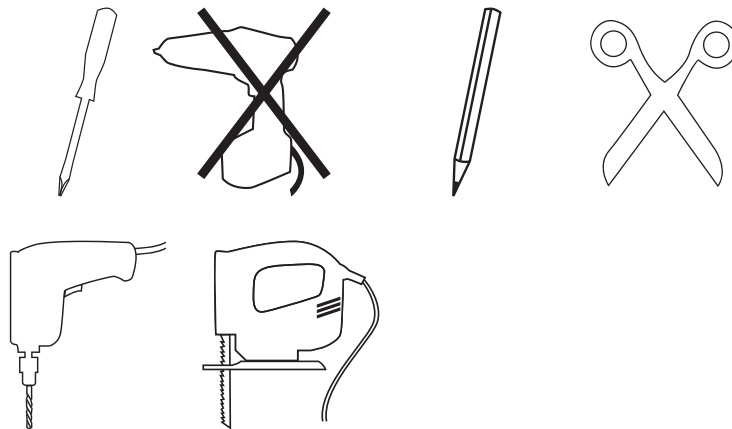



Ursågning | Utskjæring | Cut-out | Ausgeschnitten

1

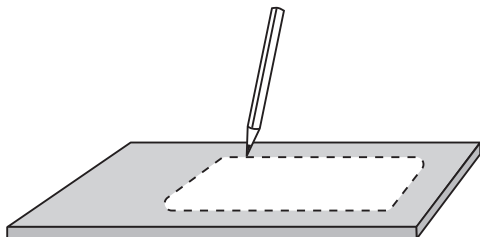

2

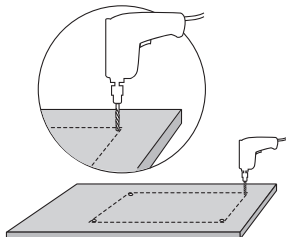

3

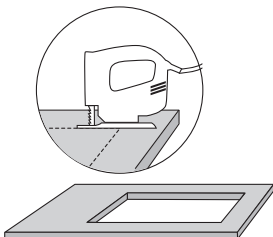

4

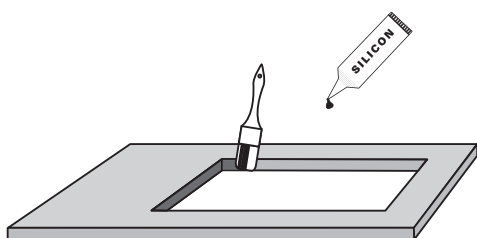



Installation | Installasjon

5

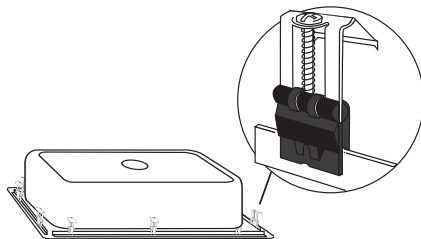

12x

14x

6

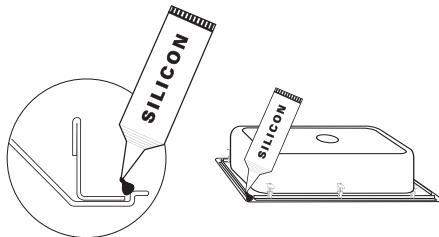

7

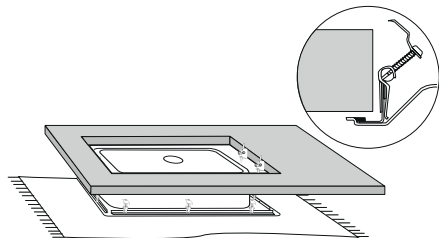



8

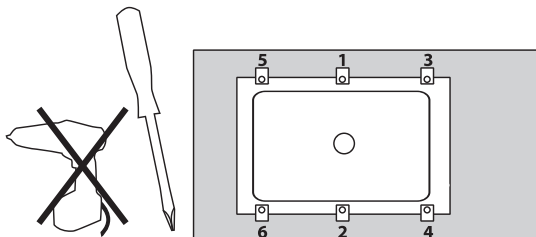

9

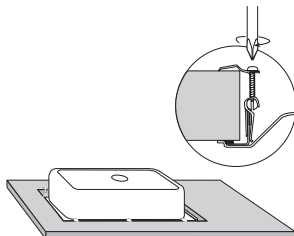

10

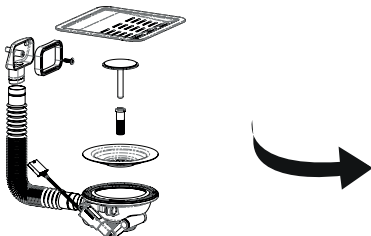



Elektronik | Electronics – Standard

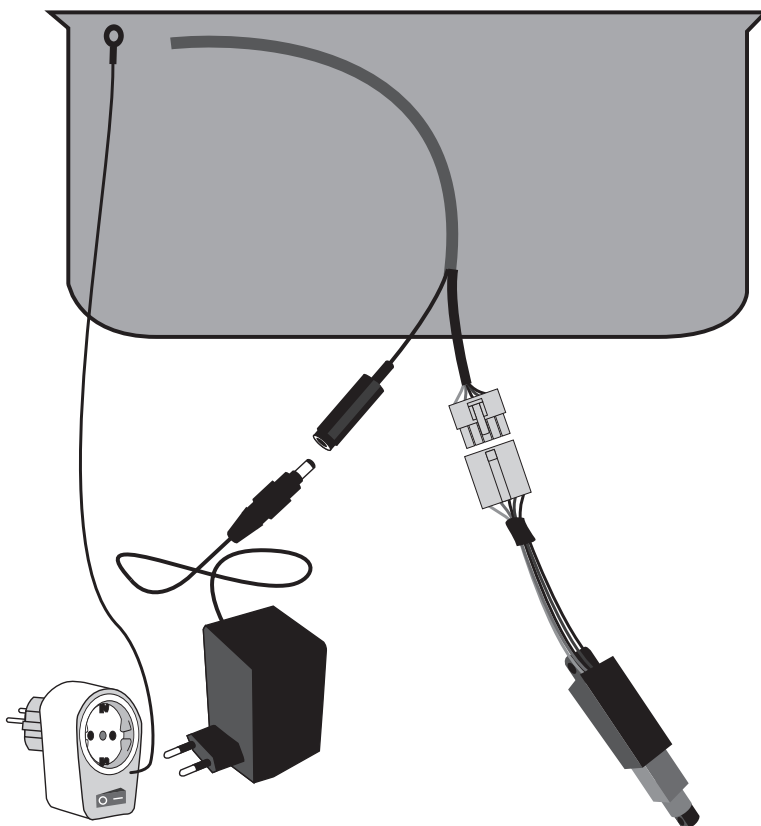
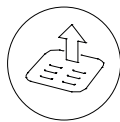
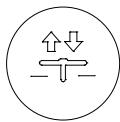



Elektronik | Electronics – DW

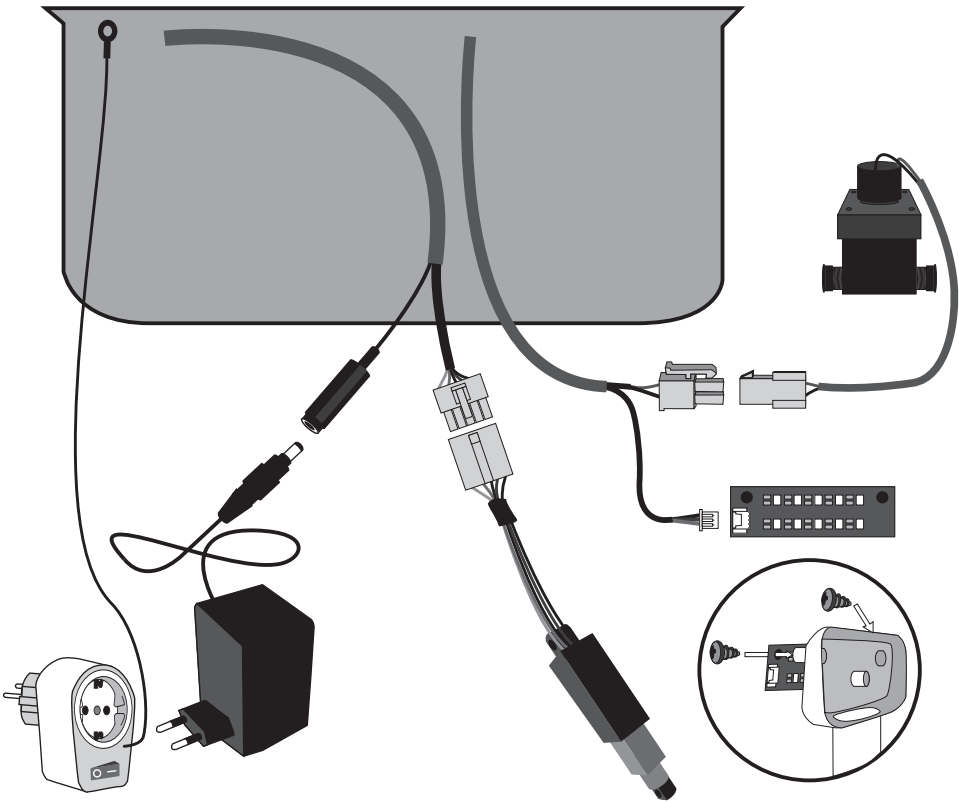
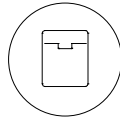
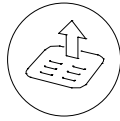
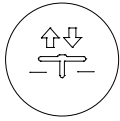



Tillbehör | Tilbehør | Accessories | Zubehör

Flexibel mellanvägg | Fleksibel delevegg | Flexible wall | Trennwand

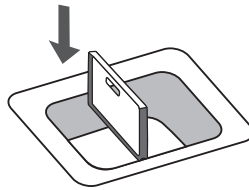

Vikbar skärbräda | Sammenleggbart skjærebrett | Foldable chopping board | Schneidbrett

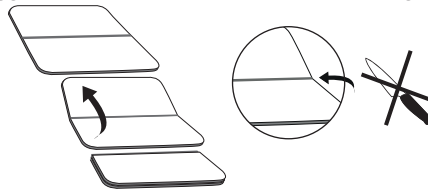

Rensskål | Skyllekurv | Colander | Resteschale

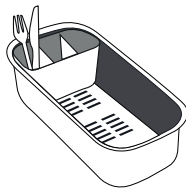

Bestickskål | Bestikkskål | Cutlery basket | Besteckkorb

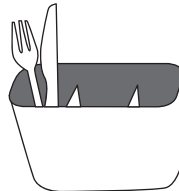
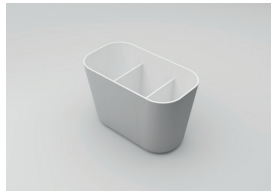



Driftsproblem | Operating problems | Bedienungsprobleme

SVENSKA

Är enheten korrekt inkopplad?

Är ställdon och transformator korrekt inkopplade?

Är stickkontakten inkopplad i vägguttaget?

Kontrollera säkringen i el-centralen.

Service och reservdelar kan erhållas genom våra återförsäljare.

NORSK

Er enheten riktig tilkoblet?

Er aktuator og transformator riktig tilkoblet?

Er stikkkontakten tilkoblet i vegguttaket?

Kontroller sikringen i el-skapet.

Service og reservedeler kan skaffes via våre forhandlere.

ENGLISH

Is the unit correctly installed?

Are the actuator and the transformer correctly connected?

Is the plug plugged in?

Check the fuse in the electrical center

Service and spare parts can be ordered via our sales reps.

DEUTSCH

Ist die Einheit korrekt installiert?

Sind der Motor und der Transformator korrekt verbunden?

Ist der Stecker eingesteckt?

Kontrollieren Sie die Sicherungen in Ihrem Schaltkasten.

Kundendienst und Ersatzteile können durch unsere Vertriebsmitarbeiter geordert werden.





Tekniska data

IntraEligo	
AC/DC transformator	Batteritransformator 230VAC / 5VDC. Stickpropp med jord.
Ventilset	Inklusive 5 V ställdon.
Piezo touch kontroller	Kretskort med touch funktioner.
Temperatur	0-55 °C
DW-modeller (inkl diskmaskinsavstängning)	
Magnetventil	5 V magnetventil. Koppling G ½”.
LED kort	Blå LED lysdioder
Tillbehör, materialspecifikation	
Skrapa	Rostfritt med silikonkant
Propp	Rostfritt med TPE
Rensskål	PP/ TPE
Bestickskål	PP/ TPE
Skärbräda	PP/ TPE
Mellanvägg	PP/ TPE
CE	EN13310 EN61058-1:2002 & A2:2008 Inkl EMC





Tekniske data

Intra Eligo	
AC/DC transformator transformer	Batteri transformator 230VAC / 5VDC. Stikkpropp med jord.
Ventilsett afløbssæt	Inklusive 5 V aktuator.
Piezo touch kontroller touchpanel	Kretskort PCB med touch funksjoner.
Temperatur	0-55 °C
DW-modeller (inkl avstenging afluk for oppvaskmaskin)	
Magnetventil	5 V magnetventil. Kobling G ½”.
LED kort	Blå LED lysdioder
Tilbehør, materialspesifikasjon	
Skrape skraber	Rustfritt med silikonkant
Propp	Rustfritt med TPE
Skyllekurv	PP/ TPE
Bestikkskål bestikkurv	PP/ TPE
Skjærefjøl skærebræt	PP/ TPE
Delevegg skilleveg	PP/ TPE
CE	EN13310 EN61058-1:2002 & A2:2008 Inkl EMC





Technical facts

Intra Eligo	
AC/DC transformer	Battery transformer 230VAC / 5VDC. Plug with earth.
Waste kit	Including 5 V actuator.
Piezo touch	PCB with touch.
Temperature	0-55 °C
DW-models (incl dishwasher switch)	
Solenoid valve	5 V solenoid valve. Connection ½” .
LED card	Blue LEDs
Accessories, materials	
Scraper	Stainless steel with silicone
Plug	Stainless steel with TPE
Colander	PP/ TPE
Cutlery basket	PP/ TPE
Chopping board	PP/ TPE
Flexible wall	PP/ TPE
CE	EN13310 EN61058-1:2002 & A2:2008 Incl EMC





Technischen Daten

Intra Eligo	
AC/DC Transformator	Batterie Transformator 230VAC / 5VDC. Verbinden mit Masse.
Ablaufgarnitur	Inklusive 5V Motor.
Piezo Touchpad	PCB Berührungsfeld.
Temperatur	0-55 °C
DW-Modelle (inkl. Geschirrspüler Ventil)	
Magnetventil	5 V Magnetventil. Verbindung ½".
LED Platine	Blaue LEDs
Zubehör, Materialien	
Scraper	Rostfreier Edelstahl mit Silikon
Verschlussstopfen	Rostfreier Edelstahl mit TPE
Resteschale	PP/ TPE
Besteckkorb	PP/ TPE
Schneidbrett	PP/ TPE
Trennwand	PP/ TPE
CE	EN13310 EN61058-1:2002 & A2:2008 Inkl. EMC





intra
SCANDINAVIAN DESIGN

www.intra-teka.com

A COMPANY OF THE **teka**-GROUP

